

STAHLGLASS One leaf glazed door REI 30 - REI 60 - RE 120

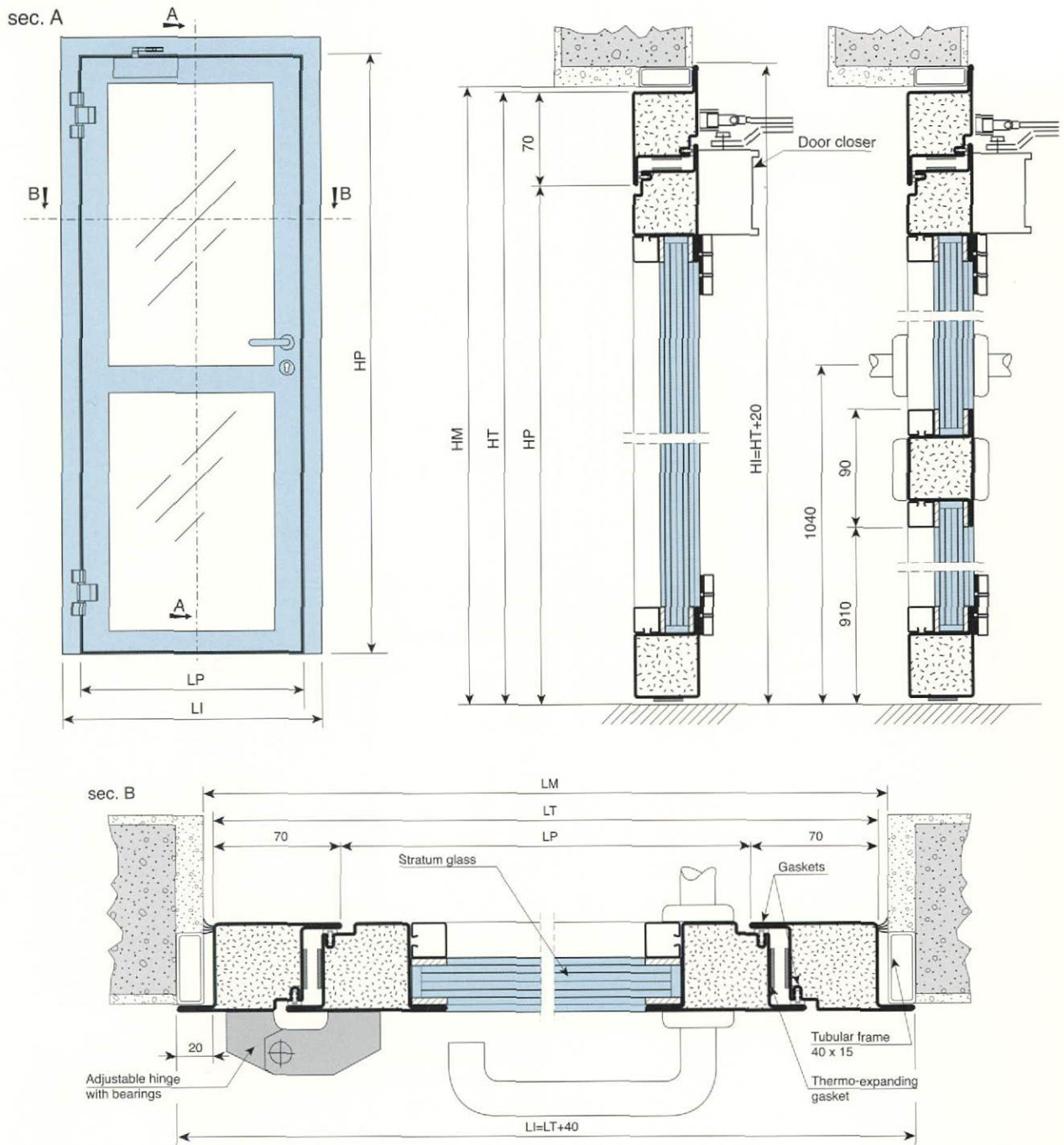

Fire proof glazed door one leaf according to norm UNI 9723

- Frame and leaf frame manufactured in tubular profile 15/10 mm., calibrated, welded on angles, with double spaces to insert rubber gasket. The particular construction of the door permits a perfect alignment between leaf and frame. Tubular profiles are filled with a subliming substance and have a particular drilling on the hidden side in order to limit the thermal conduction. Thermo-expanding gasket on the perimeter.
- Glasses are composed by several stratum of float glass and special clear gel that, in case of fire, becomes blind and gives out refreshing steam. Glasses are fixed by metal profiles clipped on hidden screws.
- n. 2 hinges each leaf, manufactured in sinterized steel sliding on two steel roller bearings, oversized for intensive usage in condition of heavy loads. Their construction allows the adjusting of the leaf position in every moment by means of special screws, normally hidden by plastic cups.
- Black handle with inside steel armour.
- Door closer colour black.
- Lock on the active leaf complete of cylinder with three keys
- Painting in RAL colours (brushed) to choose from a list of available colours. On request with aluminium covering.
- Installation possible on tubular preframe already installed on customer care, or by dowels.
- Approx. Weight REI 30 = 40 kg/m², REI 60 = 60 kg/m², RE 120 = 12,50 kg/m².